



Zanco
Air Conditioners

Zanco, Air Of Life

Hvac Product
Fan Coil Catalogue
Updated 2025



- +98114121
- +989120586090
- +989304926463
- zanco.co
- zanco.hvac@gmail.com
- www.zanco.co

- Sales Office**
Unit 302, 3rd Floor, Ghaem Building
Aftab 15.2, Haraz St., Amol, Mazandaran, Iran
- Factory**
No. 75, East Eighth Street, Khoramdasht Boulevard
Abali Road, Pardis, Tehran, Iran

Zanco, With Guarantee Of Jahan Tasisat Diaco Pars

About Zanco

Jahan Tasisat Diaco Pars Company Has Been Working In The Field Of Consulting, Design, Sales And After-Sales Services Of Advanced Air Conditioning Systems Since 2008 With The Aim Of Providing Services Higher Than The Common Standards In The Country.

Our Most Important Goal Is To Achieve Complete Customer Satisfaction And Provide Comfort And Convenience In Their Homes And Workplaces.

In A Short Time, We Have Been Able To Make Our Name And This Brand Famous In Iran With American Copeland Compressors Made In Thailand And China. In The Post-Sale Phase, Full Support In All Stages Of Design, Implementation, Installation And Remote Work Service In Short-Term Time Frames Is One Of The Main Duties Of The Technical Department Of This Company.

A Variety Of Cooling And Heating Quality Products Such As Chillers And Mini Chillers, Fan Coils And Duct Splits (Ducted Split Units) Are Part Of Our Wide Product Range.

We Believe That Honest Technical And Specialized Services And Advice Regarding Air Conditioning Systems Distinguish Us From Other Colleagues Active In This Sector. Our Technical And Engineering Consulting Services Are Provided To You In Two Stages Before And After The Sale Of The Equipment. In The Pre-Sale Phase, Our Sales And Technical Engineers Will Guide You In Making Decisions And Choosing The Best Type Of Air Conditioning Systems With Advice And Guidance. Providing Technical And Financial Proposals In The Form Of Engineering Documents And Drawings Is One Of The Free Services Of Jahan Tasisat Diaco Pars Company.

All The Offered Products Of Zanco Brand Have A Warranty Card Approved By The Consumer Rights Protection Organization And Are Subject To After-Sales Service. These Services Are Provided By The Representatives Of This Company In Tehran And Other Cities.

Over The Past Few Years, Customer Orientation And Loyalty To Commitments Have Formed The Foundation Of The Company. We Believe That With The Increasing Expectations And Demands Of Today's Smart Consumers In The Air Conditioning Industry, We Are Always Upgrading The Technical Level Of Our Products And Personnel.

Index

04 Pars Built-In Ceiling Fan Coil

08 Diaco Built-In Ceiling Fan Coil

12 Stila Ducted Fan Coil

Built-In Ceiling Fan Coil
Model : Pars
Capacity : 200-1200 Cfm
Coil : 3 Row, 12 FPI
Fan : Metalic Centrifugal Fan
Motor : Electrogen
Filter : 2 Layer Aluminium
Static Pressure : 30 Pa

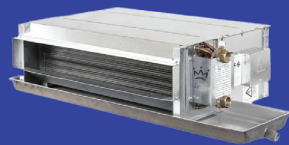

PARS				BUILT-IN CEILING FAN COIL						
MODEL				SDFC0200	SDFC0300	SDFC0400	SDFC0600	SDFC0800	SDFC1000	SDFC1200
COIL	AIR FLOW RATE (CFM)			200	300	400	600	800	1000	1200
	NOMINAL CAPACITY (BTU/HR)	COOLING	TOTAL	6200	10200	14200	21100	30100	36300	42300
			SENSIBLE	4600	7100	9600	14200	19700	23900	28000
		HEATING		21000	30600	40000	57700	78000	94600	110800
	FACE AREA (SQ.FT)			1.0	1.1	1.5	1.8	2.5	2.7	2.9
	WATER FLOW RATE (GPM)	COOLING	1.2	2.0	2.8	4.2	6.0	7.2	8.4	
		HEATING	2.2	3.0	4.0	6.0	8.0	9.7	11.3	
	PIPING CONNECTION (IN)			3/4	3/4	3/4	3/4	3/4	3/4	3/4
	FIN ROW/FPI			3/12	3/12	3/12	3/12	3/12	3/12	3/12
	MOTOR	POWER SUPPLY (V/HZ)			220/50					
INPUT POWER (HP)			1/20	1/20	1/20	1/20	1/20+1/20	1/20+1/20	1/20+1/20	
NO OF MOTOR			1	1	1	1	2	2	2	
CLASS			ELECTROGEN (CLASS:B - IP 20 - 7 MODE)							
MAX RPM			1100	1100	1100	1100	1100	1100	1100	
FAN	TYPE			CENTRIFUGAL FAN (METALLIC FORWARD CURVED)						
	NO OF FAN			1	1	2	2	3	3	4
	AIR FLOW RATE (CFM)			350	350	250	350	350	350	350
	NOISE LEVEL (dB)			38	38	40	40	40	42	44
BODY	DIMENSION (L*W*H)		Cm	80*53*24	90*53*24	100*53*24	115*53*24	155*53*24	155*53*24	155*53*24
	NET WEIGHT (Kg)			15	17	21	24	26	33	37
	FILTER			ALUMINIUM (OPTIONAL SYNTHETIC NYLON)						
	DRAIN PAN / CONNECTION			GALVANIZED / 3/4						

- Suitable For Installation In The Ceiling With A Low Height
- Three Standard Speeds With A Low Noise Level
- Possibility Of Air Return From Below And Behind
- The Possibility Of Using An Electric Heating Coil
- The Possibility Of Using Fresh Air In The Plenum
- Forged Brass Collector With Air Vent And Drain Valve
- EVA Insulator : Drain Pan : 5mm , Body : 3mm

Pars Built-In Ceiling Fan Coil Dimension

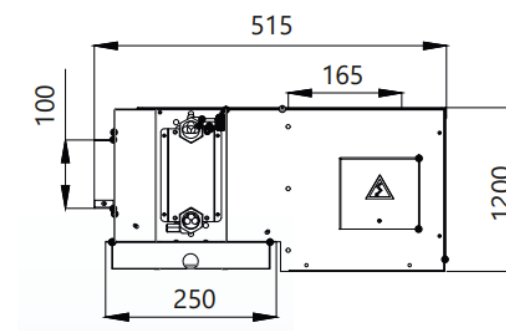
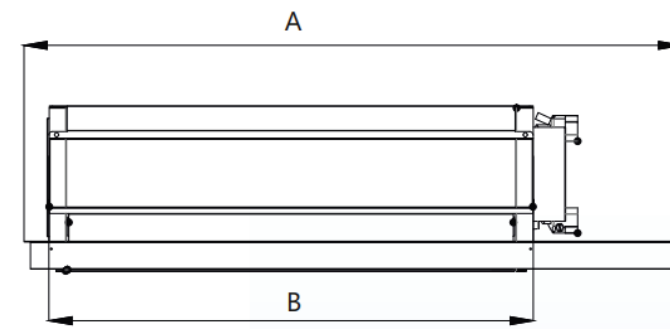

PARS	200	300	400	600	800	1000	1200
A (mm)	750	860	970	1120	1500	1500	1500
B (mm)	500	600	700	850	1200	1250	1350
C (mm)	480	580	680	830	1180	1230	1330

Fan Coil Design And Operation



Unique Features

- Advanced DC Motor
High Efficiency DC Motor | Insulation Class : B | Protection Class : IP20
- Easy-To-Access Centrifugal Fan
Easy-To-Open ABS And Metal Fan Volute Makes Service Work Easy And Simple ; High Efficient Large Centrifugal Fan Ensures Strong And Constant Air Flow Axis's And Bearings Have Been Specially Treated For Longer Service Life
- High Efficiency Heat Exchanger
Louvered Aluminum Fins And Seamless Copper Pipes Are Made Into This Top-Level Heat Exchanger
- Removable End Panel
End Panels On Both Sides Can Be Removed ; Coil Connection Orientation Can Be Easily Changed On Site
- Clean Drain Pan
Integrated Punched Drain Pan Is Covered With 5mm PE Insulation
- Leakage-Tight Header
This Safe And Secure Header Structure Is Perfectly Designed , Aiming At Totally Leakage-Free And Durable Operation
- Innovative Filter Rack
Slip-On Type Mounting Rack Allows Quick And Easy Filter Replacement
- Ultra Thin
The Unit Height Is Only 200-220mm So That They Can Save Installation Space And Meet The Requirement Of All Kinds Of Situations

- Fan Coil Unit Covers A Range Of Products And Will Mean Different Things To Users , Specifies , And Installers In Different Countries And Regions , Particularly In Relation To Product Size And Output Capability
- A Fan Coil Unit May Be Concealed Or Exposed Within The Room Or Area That It Serves
- A Concealed Fan Coil Unit Will Typically Be Installed Within An Accessible Ceiling Void Or Services Zone
- The Coil Receives Hot Or Cold Water From A Central Plant , And Removes Heat From Or Adds Heat To The Air Through Heat Transfer
- Fan Coil Units Are Divided Into Two Types : Fan Coil Units Or Ducted Fan Coil Units
- The Coil Receives Hot Or Cold Water From A Central Plant , And Removes Heat From Or Adds Heat To The Air Through Heat Transfer
- Traditionally Fan Coil Units Can Contain Their Own Internal Thermostat , Or Can Be Wired To Operate With A Remote Thermostat

Product Features

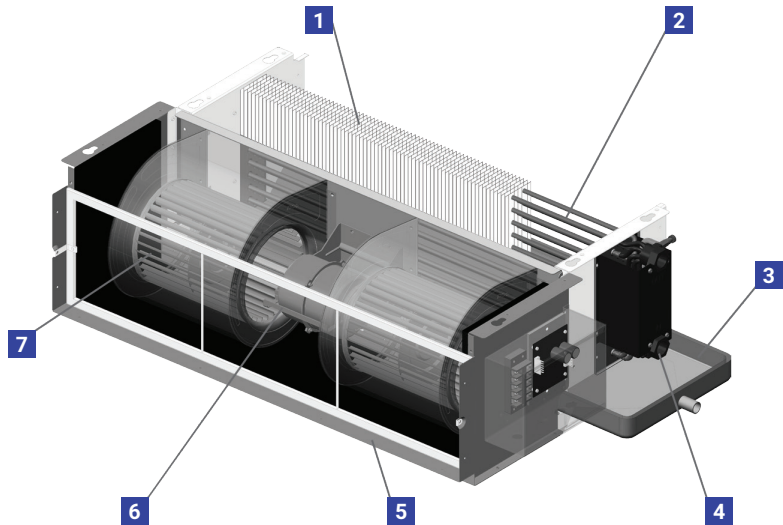

1. Fin : Fins Are Made Of Aluminum With A Thickness Of 150 Microns . Blue And Gold Coated Varieties . Fin Density 12 FPI
2. Tube : The Dimensions Of The Coil According To The Design In Different Capacities With 3 Rows Of Pipes . The Material Of The Copper Pipe And The Thickness Of The Pipe Can Withstand 20 Bar Pressure . The Ability To Turn The Coil Left And Right
3. Drain : 5mm Thick Insulation . Height 30mm , Galvanized Material With Electrostatic Paint Coating . 1/2 And 4/3 Metal Connection For Different Capacities . The Ability To Turn The Tray Left And Right
4. Connection : 3/4" Forged Fittings . Attached Screw To Prevent Twisting During Installation . Air Valve In The Highest Part Of The Outlet Drain valve at the lowest part of the inlet
5. Filter : Washable Double Layer Aluminum Filter Or Fabric Filter . Ability To Move The Filter From The Back Or Bottom Of The Device . Ability To Easily Remove The Filter By The Operator
6. Motor : Motor With Aluminum Shell And High Heat Transfer And 7 Different Speeds . Wire Connecting To The Body (Earth) . High Thickness Motor Base To Prevent Vibration
7. Fan : Ability To Install A Metal Or Plastic Fan . Using Fans With Capacities Of 200 And 300 And Different Numbers . Static Pressure 30-50 Bar For Different Capacities

- Inlet Air : Ability To Change The Suction From Behind Or Under The Device In The Design Sounding The Filter With Sealing Tape At The Connection points
- The Body Of The Device Is Made Of Galvanized Material With A Thickness Of 1mm With Minimum Vibration
- 1.5mm Galvanized Engine Tray
- Insulation Of The Device Body With 3mm Thermal Insulation
- The Ability To Connect The Channel And Valve To The Output Of The Device

Built-In Ceiling Fan Coil
Model : Diaco
Capacity : 200-1200 Cfm
Coil : 3 Row, 12 FPI
Fan : Metalic Centrifugal Fan
Motor : Electrogen
Filter : 2 Layer Aluminium
Static Pressure : 30 Pa



DIACO				BUILT-IN CEILING FAN COIL						
MODEL				SLFC0200	SLFC0300	SLFC0400	SLFC0600	SLFC0800	SLFC1000	SLFC1200
COIL	AIR FLOW RATE (CFM)			200	300	400	600	800	1000	1200
	NOMINAL CAPACITY (BTU/HR)	COOLING	TOTAL	6200	10200	14200	21100	30100	36300	42300
			SENSIBLE	4600	7100	9600	14200	19700	23900	28000
		HEATING		21000	30600	40000	57700	78000	94600	110800
	FACE AREA (SQ.FT)			1.0	1.1	1.5	1.8	2.5	2.7	2.9
	WATER FLOW RATE (GPM)	COOLING	1.2	2.0	2.8	4.2	6.0	7.2	8.4	
		HEATING	2.2	3.0	4.0	6.0	8.0	9.7	11.3	
	PIPING CONNECTION (IN)			3/4	3/4	3/4	3/4	3/4	3/4	3/4
	FIN ROW/FPI			3/12	3/12	3/12	3/12	3/12	3/12	3/12
MOTOR	POWER SUPPLY (V/HZ)			220/50						
	INPUT POWER (HP)			1/20	1/20	1/20	1/20	1/20+1/20	1/20+1/20	1/20+1/20
	NO OF MOTOR			1	1	1	1	2	2	2
	CLASS			ELECTROGEN (CLASS:B - IP 20 - 7 MODE)						
	MAX RPM			1100	1100	1100	1100	1100	1100	1100
FAN	TYPE			CENTRIFUGAL FAN (METALLIC FORWARD CURVED)						
	NO OF FAN			1	1	2	2	3	3	4
	AIR FLOW RATE (CFM)			300	300	200	300	300	300	300
	NOISE LEVEL (dB)			40	40	42	42	42	44	46
BODY	DIMENSION (L*W*H)		Cm	66*52*21	76*52*21	86*52*21	101*52*21	131*52*21	141*52*21	151*52*21
	NET WEIGHT (Kg)			18	21	25	28	32	36	42
	FILTER			ALUMINIUM (OPTIONAL SYNTHETIC NYLON)						
	DRAIN PAN / CONNECTION			GALVANIZED / 1/2						

- Suitable For Installation In The Ceiling With A Low Height
- Three Standard Speeds With A Low Noise Level
- Possibility Of Air Return From Below And Behind
- An External Plastic Drain Pan
- The Possibility Of Using An Electric Heating Coil
- The possibility of using fresh air in the plenum
- Forged brass collector with Air vent and Drain Valve
- EVA Insulator: Drain Pan: 5mm, Body: 3mm

Diaco Built-In Ceiling Fan Coil Dimension

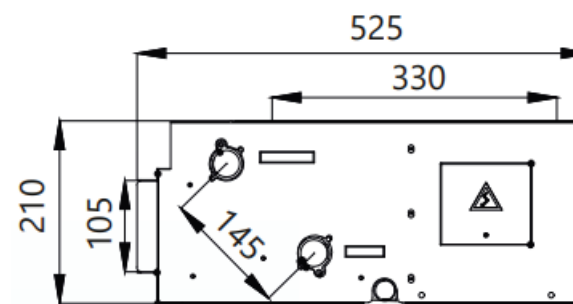
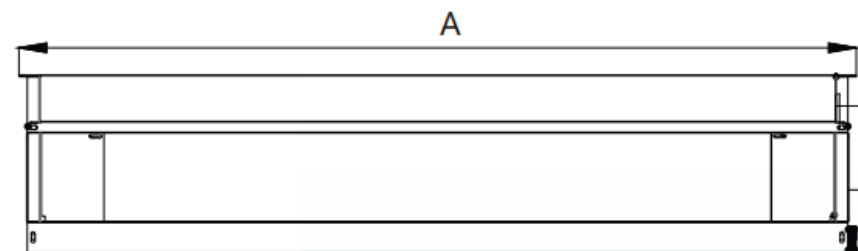

DIACO	200	300	400	600	800	1000	1200
A (mm)	675	775	875	1025	1325	1425	1525
B (mm)	630	730	830	980	1280	1380	1480

Fan Coil Unit



Pars Built-In Ceiling Fan Coil

Capacity : 200-1200 CFM
3R – 8P – 12FPI
Height : 240mm



Diaco Built-In Ceiling Fan Coil

Capacity : 200-1200 CFM
3R – 8P – 12FPI
Height : 210mm

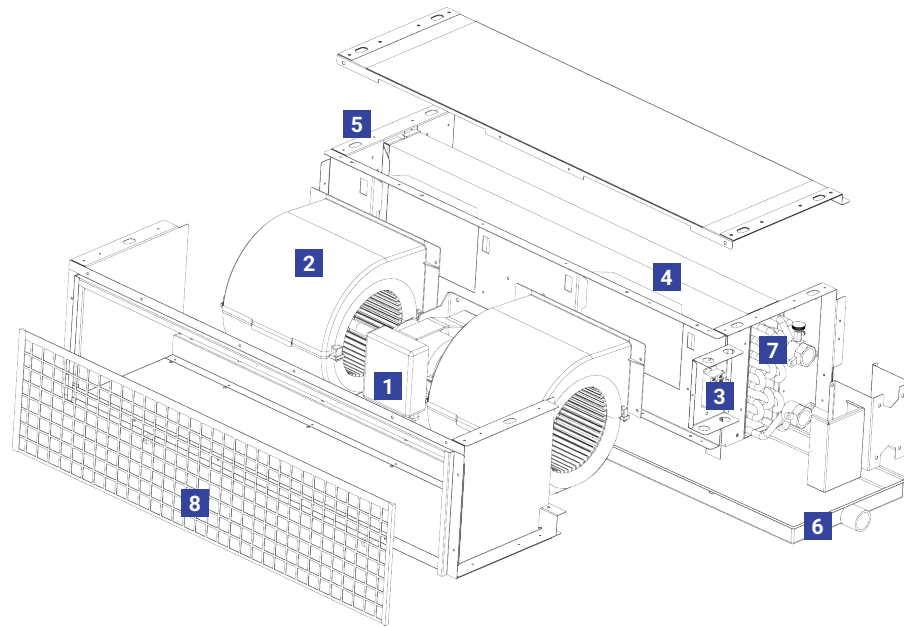

Fan Coil Features

CC : Ceiling Concealed Without Plenum Or Filter

CD : Ceiling Concealed With Down / Back Return Plenum & Filter

1. Motor
2. Fan
3. Electrical Box
4. Coil
5. Panel
6. Drain Pan
7. Collector
8. Filter

Fan Coil Unit

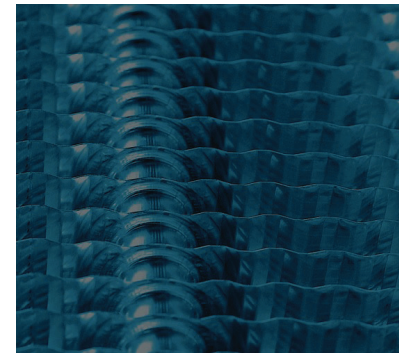
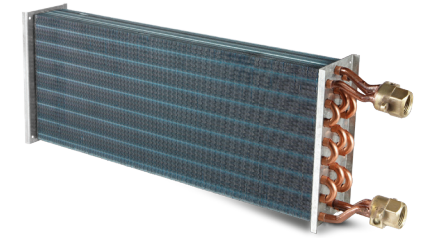
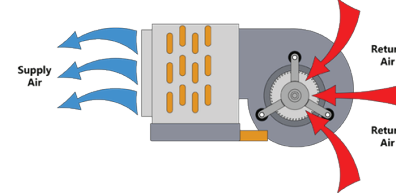

150 Micron Aluminium Fin

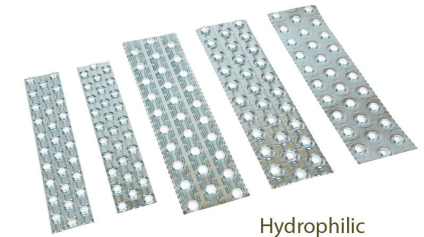

Hydrophilic

Coils

- All Cooling And Heating Coils Shall Optimize Rows And Fins Per Inch To Meet The Specified Capacity . Coils Shall Have Seamless Copper Tubes And Shall Be Mechanically Expanded To Provide An Efficient , Permanent Bond Between The Tube And Fin
- Fins Shall Have High Efficiency Aluminium Surface Optimized For Heat Transfer , Air Pressure Drop And Carryover . Heating Coils Shall Be Furnished In The Reheat Position As Standard
- Direct Expansion Cooling Coils Shall Include A Fixed Orifice Metering Device . All Evaporator Coils Shall Be Factory Sealed And Charged With A Minimum 5PSIG Nitrogen Or Refrigerated Dry Air

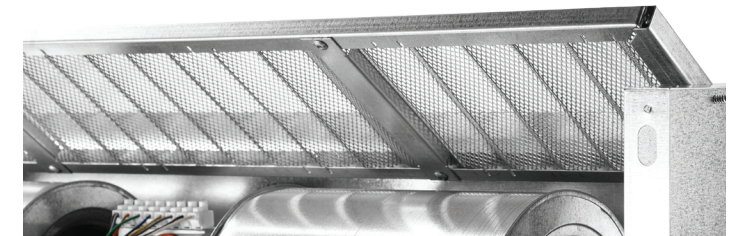
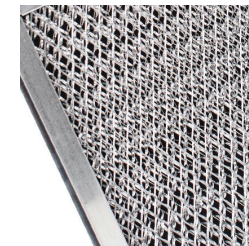

Filters

- All units shall be made by Aluminium filters. Filters shall be tight fitting to prevent air bypass. Filters shall be easily removable from the return air opening without the need for tools or removal of the front panel. the return air opening

Ducted Fan Coil
Model : Stila
Capacity : 600-2000 Cfm
Coil : 4 Row, 12 FPI
Fan : Metallic Centrifugal Fan
Motor : Electrogen
Filter : 2 Layer Aluminium
Static Pressure : 50 Pa



STILA				DUCTED FAN COIL							
MODEL				MSDF0600	MSDF0800	MSDF1000	MSDF1200	MSDF1400	MSDF1600	MSDF1800	MSDF2000
COIL	AIR FLOW RATE (CFM)			600	800	1000	1200	1400	1600	1800	2000
	NOMINAL CAPACITY (BTU/HR)	COOLING	TOTAL	23800	29100	35100	40800	48000	55400	61100	66700
			SENSIBLE	15700	19600	23900	27900	32700	37500	41500	45500
		HEATING		67000	84700	102700	120000	139500	158800	175900	192800
	FACE AREA (SQ.FT)			2.0	2.0	2.1	2.3	2.5	2.8	3.0	3.1
	WATER FLOW RATE (GPM)		COOLING	4.7	5.8	7.0	8.1	9.6	11.0	12.2	13.3
			HEATING	7.0	8.7	10.5	12.3	14.5	16.3	18.0	19.7
	PIPING CONNECTION (IN)			1	1	1	1	1	1	1	1
	FIN ROW/FPI			4/12	4/12	4/12	4/12	4/12	4/12	4/12	4/12
MOTOR	POWER SUPPLY (V/HZ)			220/50							
	INPUT POWER (HP)			60	187	187	187	187	187+60	187+80	187+80
	NO OF MOTOR			1	1	1	1	1	2	2	2
	CLASS			ELECTROGEN (CLASS:B - IP 20)							
	MAX RPM			1350	1350	1350	1350	1350	1350	1350	1350
FAN	TYPE			Centrifugal Fan (Metallic Forward Curved)							
	NO OF FAN			2	2	2	2	2	3	3	3
	AIR FLOW RATE (CFM)			400	600	600	750	750	600	750	750
	NOISE LEVEL (dB)			48	50	52	52	54	58	60	62
BODY	DIMENSION (L*W*H)		Cm	100*50*30	100*50*30	105*50*30	110*50*30	120*50*30	130*50*30	135*50*30	140*50*30
	NET WEIGHT (Kg)			30	33	36	40	45	50	52	54
	FILTER			Aluminium (Optional Synthetic Nylon)							
	DRAIN PAN/ CONNECTION			Galvanized / 3/4							

- Suitable For Installation In The Ceiling With A Low Height
- Three Standard Speeds With A Low Noise Level
- Possibility Of Removing Filter From 4 Direction
- The Possibility Of Using An Electric Heating Coil
- The Possibility Of Using Fresh Air In The Plenum
- Forged Brass Collector With Air Vent And Drain Valve
- EVA Insulator: Drain Pan: 5mm, Body: 3mm

Stila Ducted Fan Coil Dimension

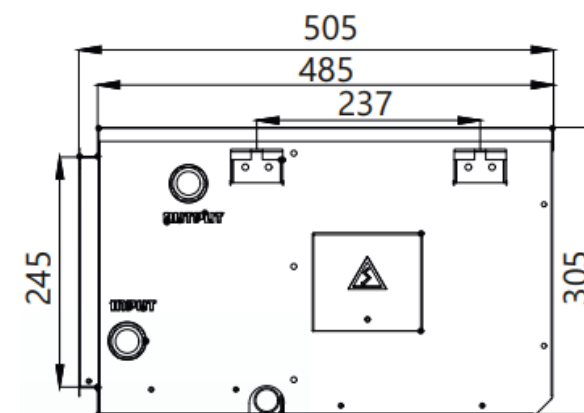
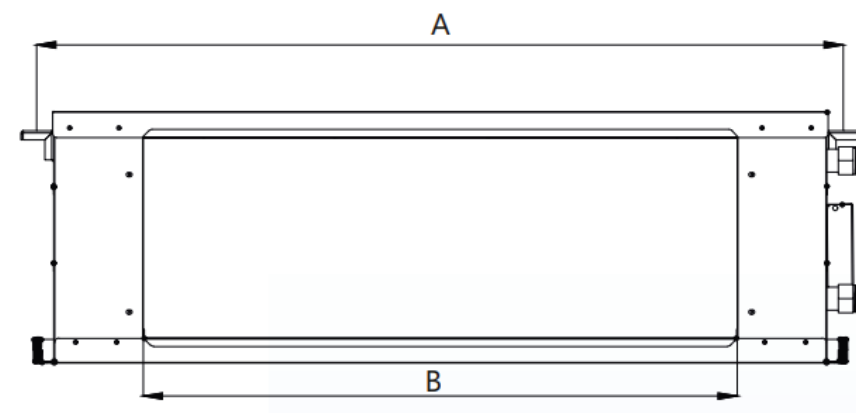

STILA	600	800	1000	1200	1400	1600	1800	2000
A (mm)	950	950	1000	1050	1150	1250	1300	1350
B (mm)	692	692	742	792	892	992	1042	1092